

PRODUCT NUMBER
73326-XXXLF

PLATING OPTION	
1=	GXT 0.76 μm
3=	GOLD 0.76 μm
5=	GOLD 1.27 μm

PACKAGE OPTION	
1=	TAPE ON REEL
2=	TUBE

TERMINAL LOADING	
1=	FULLY LOADED
2=	POS 2,3,4,5
3=	POS 1,2,5,6

WHEN NEEDED, SUFFIX LETTER "LF" INDICATES THE PRODUCT IS RoHS COMPATIBLE, SEE NOTE 4.

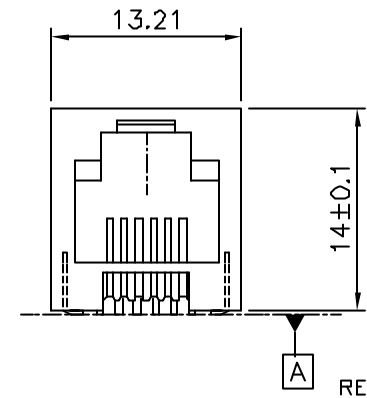
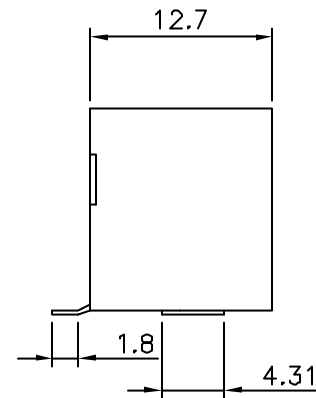
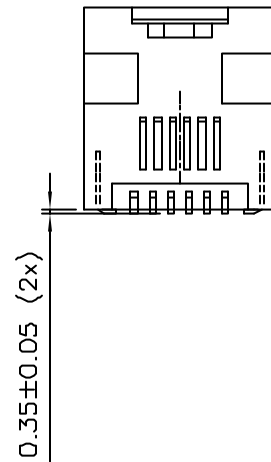

REFERENCE PLAN DEFINED BY THE 2 HOLD DOWN BEARING SURFACE

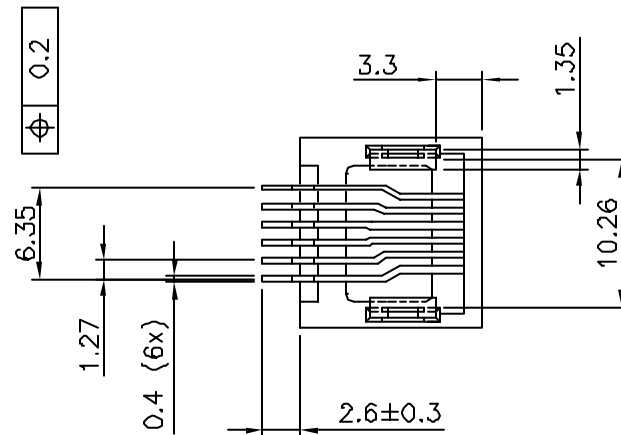

VIEW ACCORDING "V"

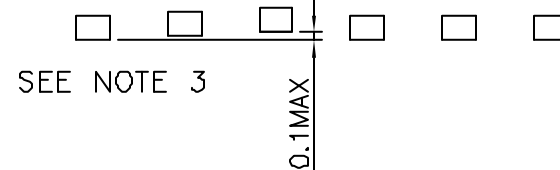

SEE NOTE 3

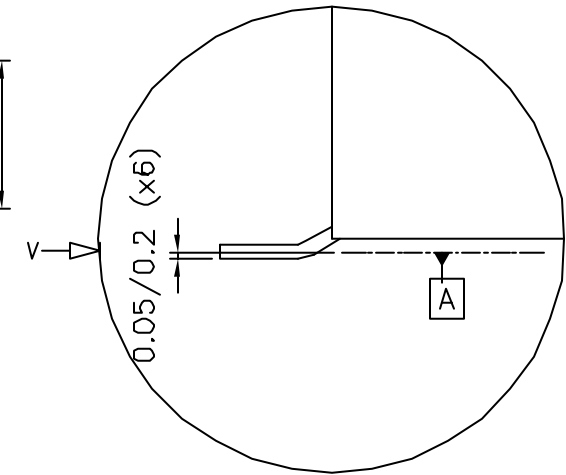

NOTES:

- 1 - MATERIAL: HOUSING: HIGH TEMP. NYLON, COLOUR BLACK.
TERMINAL: PHOSPHOR BRONZE.
- 2 - PLATING: CONTACT AREA: SEE TABLE.
SOLDER TAIL : 90/10 SnPb 2 μm MIN.
WHEN SUFFIX "LF" IS REQUIRED, 2 μm MIN MATTE TIN OVER 1.27 MIN Ni IS SUPPLIED INSTEAD OF SnPb.
NO RAW EDGES EXCEPT SOLDER TAIL TIPS
- 3 - SOLDER TAILS COPLANARITY : 0.1 mm
- 4 - RoHS COMPATIBLE PRODUCT SPECIFICATIONS
 - a - PLATING:
 - "LF" MEANS THE PRODUCT IS LEAD-FREE, 2 μm MINIMUM MATTE TIN OVER 1.27 μm MINIMUM NICKEL UNDERPLATE.
 - b - MANUFACTURING PROCESS COMPATIBILITY
 - THE HOUSING WILL WITHSTAND EXPOSURE TO 245°C PEAK TEMPERATURE FOR 30 SECONDS MAX IN A CONVECTION, INFRA-RED OR VAPOR PHASE OR REFLOW OVEN.
 - c - LABELING:
 - MEETS PACKAGING SPECS AS PER GS-14-920
 - d - LEGAL STATEMENT: SEE GS-22-008

CUSTOMER COPY FOR REFERENCE ONLY

mat'l. code				surface ISO 1302 <input checked="" type="checkbox"/> ISO 406 <input type="checkbox"/> ISO 1101		tolerance ISO 406 <input type="checkbox"/> ISO 1101		projection 		product family MOD JACK	
ltr				ecn no		dr		date		title	
H				06-024C		DLE		06.07.18		SMT RA JACK 6 POS INSIDE	
C				FB0608		DLE		98.08.19		scale 2:1	
D				FB0620		DLE		98.11.26		sheet 1 of 3	
E				F03020		DLE		03.01.27		size	
F				F04-0363		DLE		04.10.18		73326	
G				F05-0247		DLE		05.09.12		A3	
sheet index				revision		H		E		B	
1				sheet		1		2		3	
										type CUSTOMER Drawing	

PRODUCT NUMBER
SEE SHEET 1

LTR	PART NAME	QTY
1	PRODUCT	230
2	TAPE	1
3	REEL	1
4	COVER TAPE	1

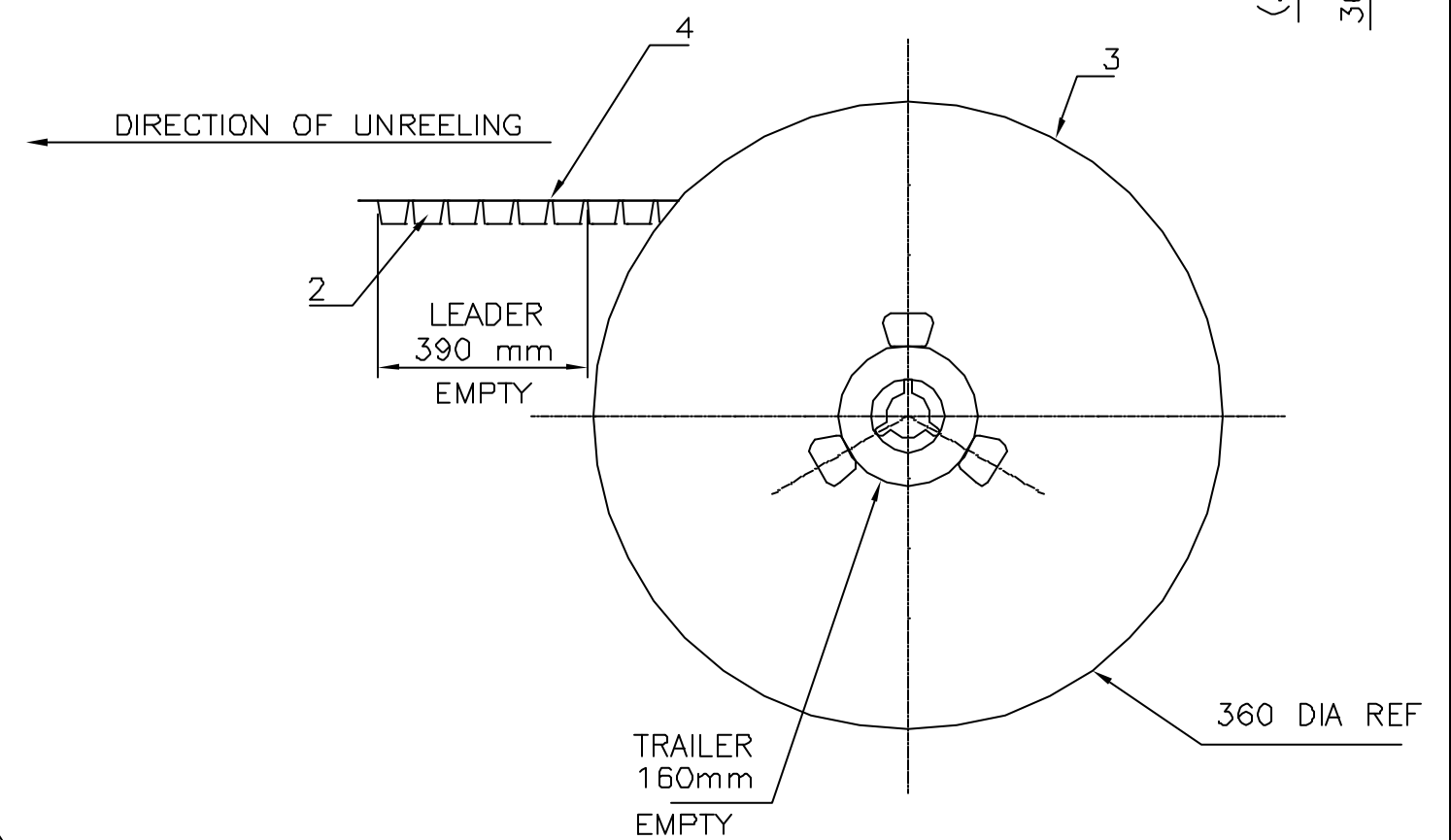
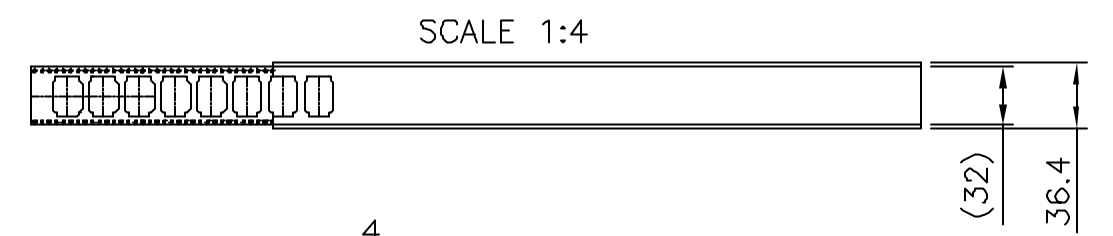
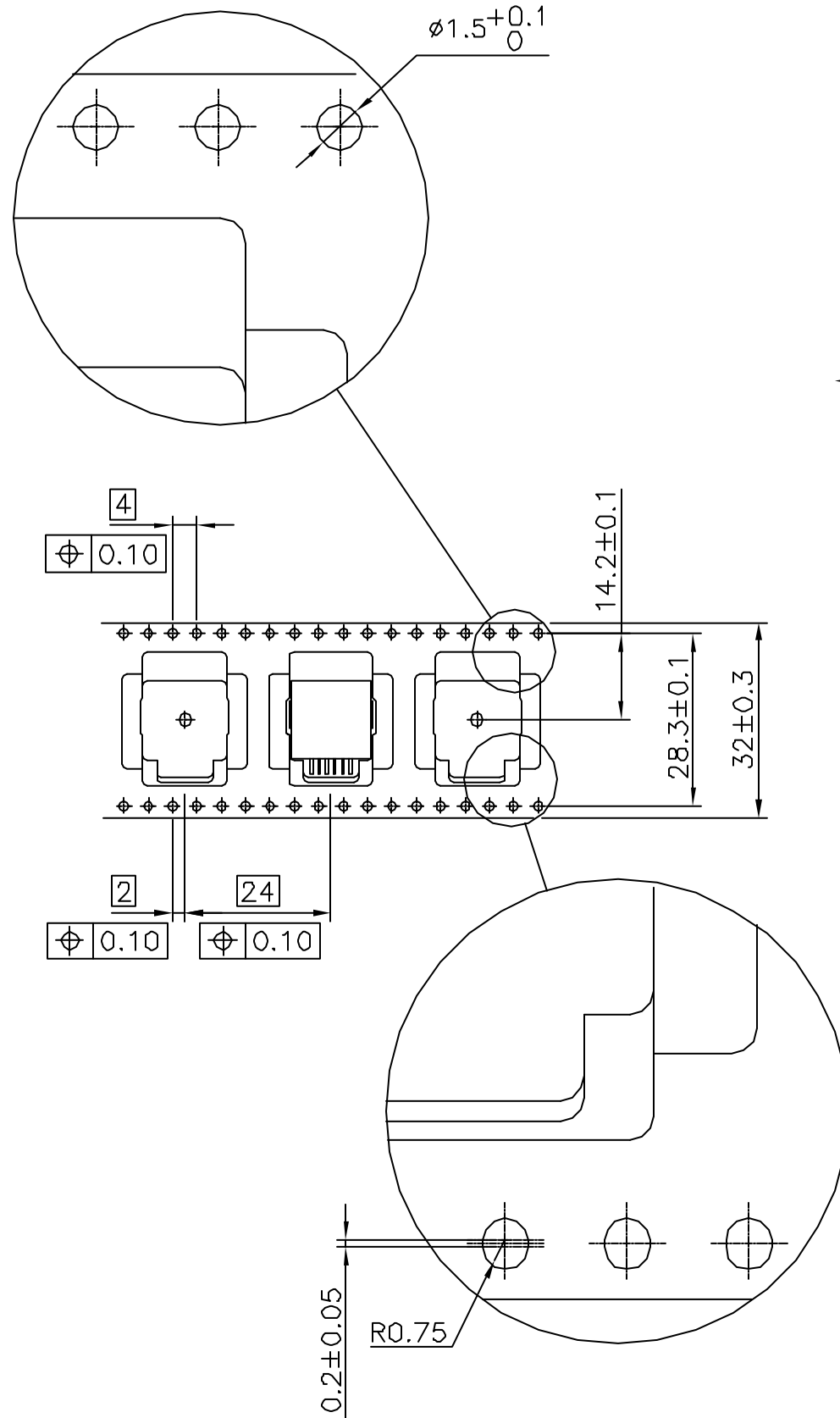

1- IN ACCORDANCE WITH EIA-481 AND IEC 296-3

CUSTOMER COPY FOR REFERENCE ONLY

mat'l. code		surface ISO 1302 ✓		tolerance ISO 406 ISO 1101		projection mm		product family MOD-JACK		
Ltr	ecn no	dr	date	tolerances unless otherwise specified		mm		title		
D	F80620	DLE	98.11.26	angles		mm		SMT RA JACK		
E	F06-0240	DLE	06.07.18	linear		scale 1:1		6 POS. INSIDE		
		dr	D LEGRAND	06.07.18			dwg no		sheet 2 of 3	size
		enr	P NIZZI	06.07.18			73326		A3	
		chr	D LE	06.07.18			type		CUSTOMER Drawing	
		app	P NZ	06.07.18						
sheet index	revision sheet									



Copyright FCI

form A3

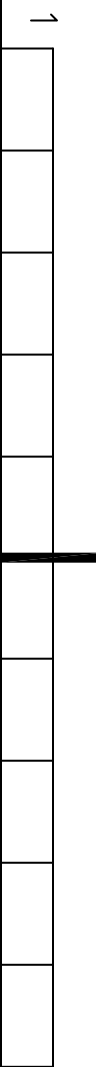

2

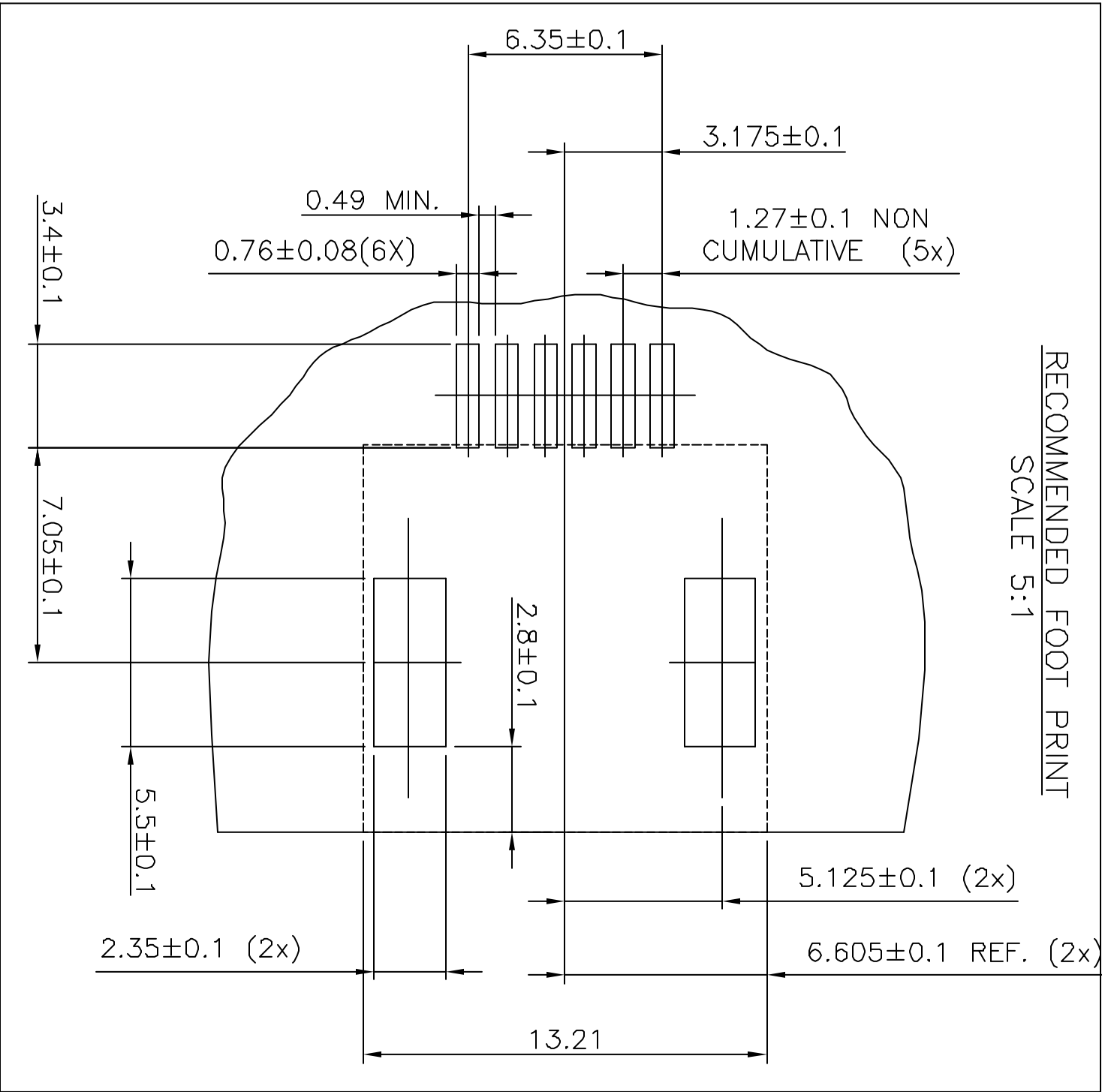

CUSTOMER COPY FOR REFERENCE ONLY

mat'l. code		surface		tolerance		projection		product family	
ISO 1302		ISO 406		ISO 1101		mm		MOD JACK	
tolerances unless otherwise specified		±2°		±0.13		scale 2:1		title	
angles linear		D LEGRAND		04.10.18		SMT RA JACK		product no	
dr		P NIZZI		04.10.18		6 POS INSIDE		sheet 3 of -	
engr		D LEGRAND		04.10.18		CUSTOMER Drawing		size	
chr		P NZ		04.10.18				A4	
appd									
sheet index		revision							
D		sheet							